

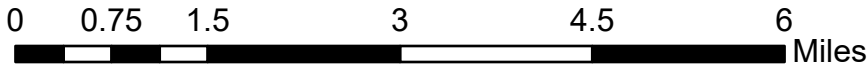

Volunteer Wildlife Monitoring Program (VWMP) Frog and Toad Survey

Inactive Route Map Route ID: 360201 County: Sioux

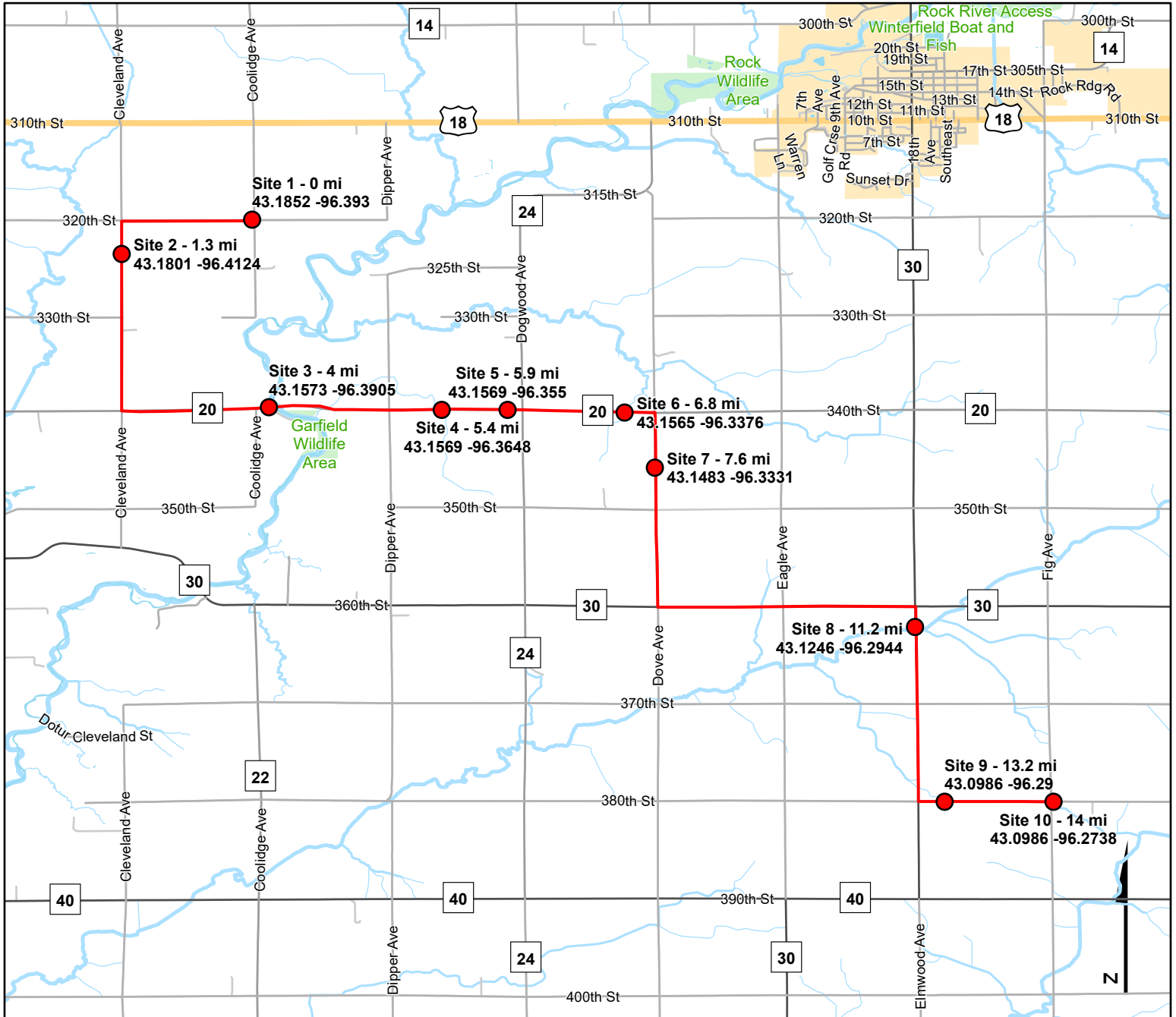

- Frog and Toad Survey Sites
- Frog and Toad Survey Route



Questions? Contact the VWMP Coordinator at vwmp@dnr.iowa.gov.
Created on: 4/4/2019

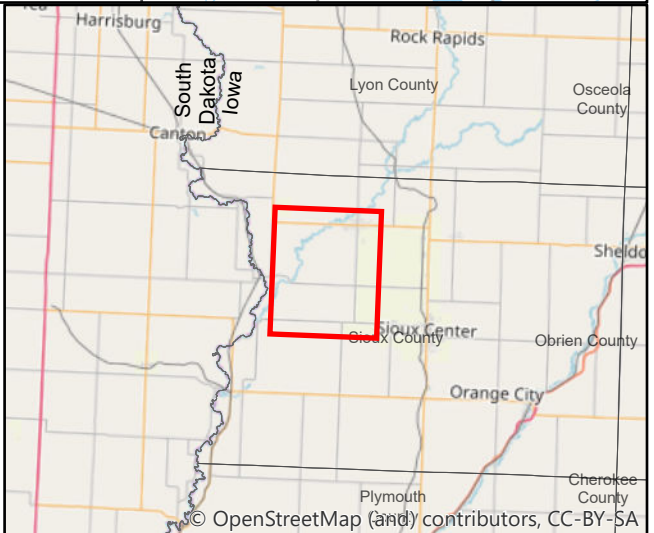

© OpenStreetMap (and) contributors, CC-BY-SA



Frog and Toad Call Survey Route Description

Route ID **360201**

Established:

Site Number	Name	County	Latitude	Longitude	Directions
1	0	Sioux	43.1851997	-96.3929977	Intersection of Coolidge and 320th facing west on 320th. Deep ditches on either side. Holding water in 2010.
2	1.3	Sioux	43.1800995	-96.4123993	Turn left (south) on Cleveland and go 0.3 miles. Ditch on left with cattails. On right is a small shallow stream running through crop field. Pools by road a bit.
3	4	Sioux	43.157299	-96.3905029	Turn left (east) on 340th. Next stop is at bridge over Rock River. There is a field pull off on the right.
4	5.4	Sioux	43.1568985	-96.3647995	Continue east on 340th, cross over Dipper. Stop in valley by narrow small stream running through crop on left, pasture on right.
5	5.9	Sioux	43.1568985	-96.3550034	Continue east on 340th. Just before you hit a stop sign there is a large patch of cattails in the ditch on the left.
6	6.8	Sioux	43.1565018	-96.3376007	Continue east on 340th crossing over Dogwood. Stop is at small grassy creek running under road. To the left in a cropfield is a small clump of willows - possibly a small pool or pond.
7	7.6	Sioux	43.1483002	-96.3330994	Turn right (south) on Dove. Stop in Valley, crops on both side. Large patch of cattails on right with grassed waterway running through field.
8	11.2	Sioux	43.1245995	-96.2944031	Continue south on Dove, turn left onto 360th, go 2 miles to K30 (Elmwood) and turn south. Stop just before small bridge. There is a field pull off on the right.



Frog and Toad Call Survey Route Description

9	13.2	Sioux	43.0985985	-96.2900009	Turn left on 380th and stop shortly at small narrow creek running through a cropfield on the left just past church.
10	14	Sioux	43.0985985	-96.2738037	Continue east on 380th. Stop just after crossing over Fig. Small ditched creek on right.