

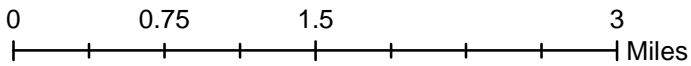

Volunteer Wildlife Monitoring Program (VWMP) Frog and Toad Survey

Route ID: 360107 Start County: Woodbury

Click for Google Maps to Site 1: <https://www.google.com/maps/dir/?api=1&destination=42.4305992,-96.1969986>

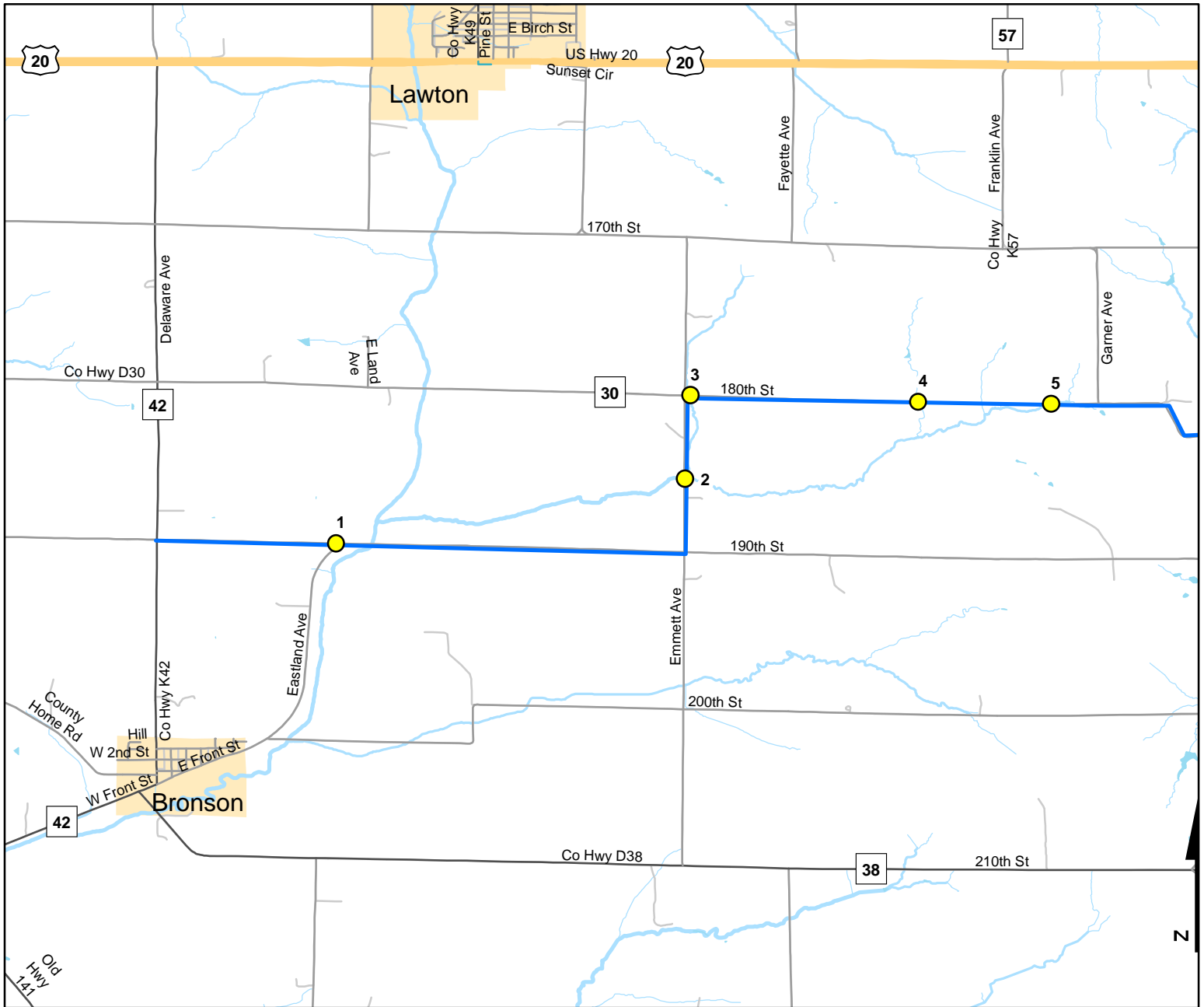

Legend

● Stop Locations

— Route Path

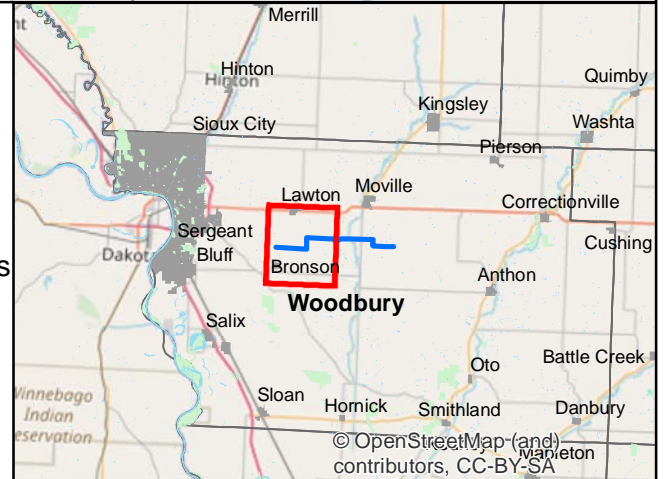



Volunteer Wildlife Monitoring Program (VWMP) Frog and Toad Survey

Route ID: 360107 Start County: Woodbury

Click for Google Maps to Site 1: <https://www.google.com/maps/dir/?api=1&destination=42.4305992,-96.1969986>

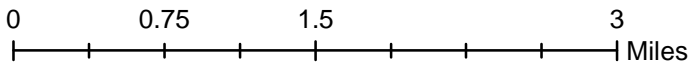
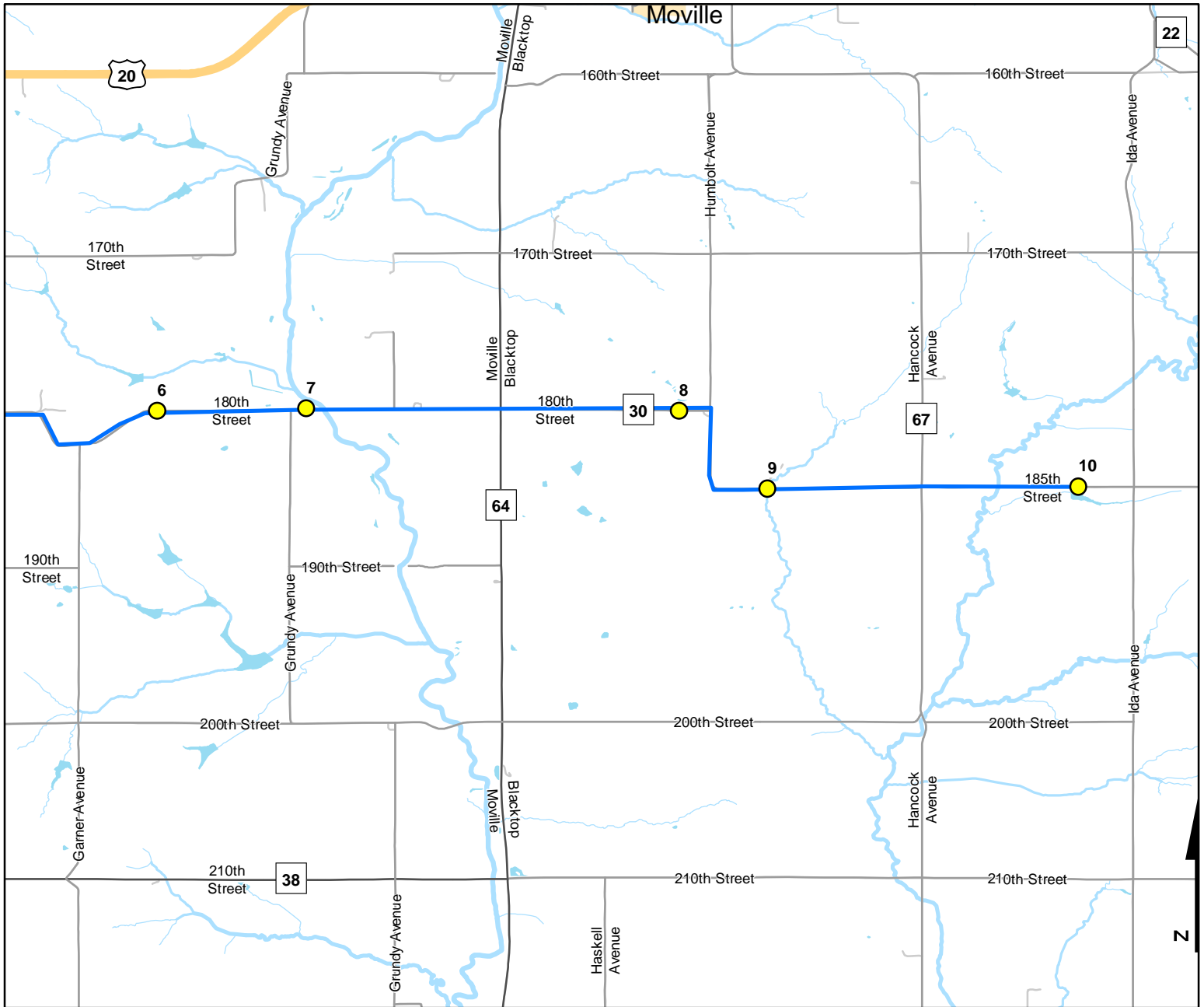

Legend

● Stop Locations

— Route Path

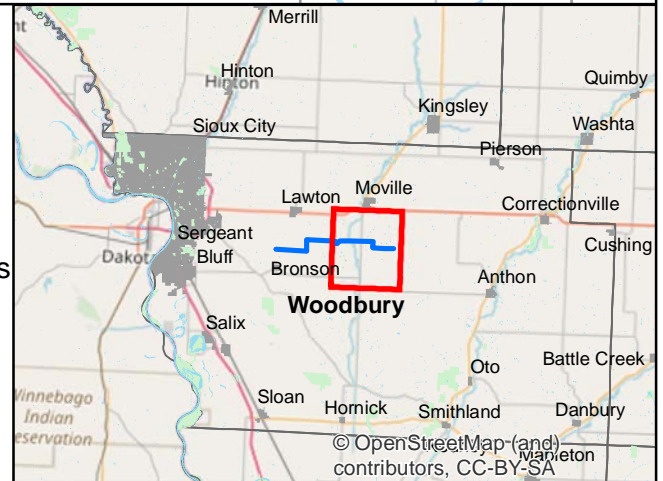



Volunteer Wildlife Monitoring Program (VWMP) Frog and Toad Survey

Route ID: 360107 Start County: Woodbury

Click for Google Maps to Site 1: <https://www.google.com/maps/dir/?api=1&destination=42.4305992,-96.1969986>

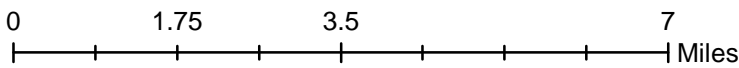
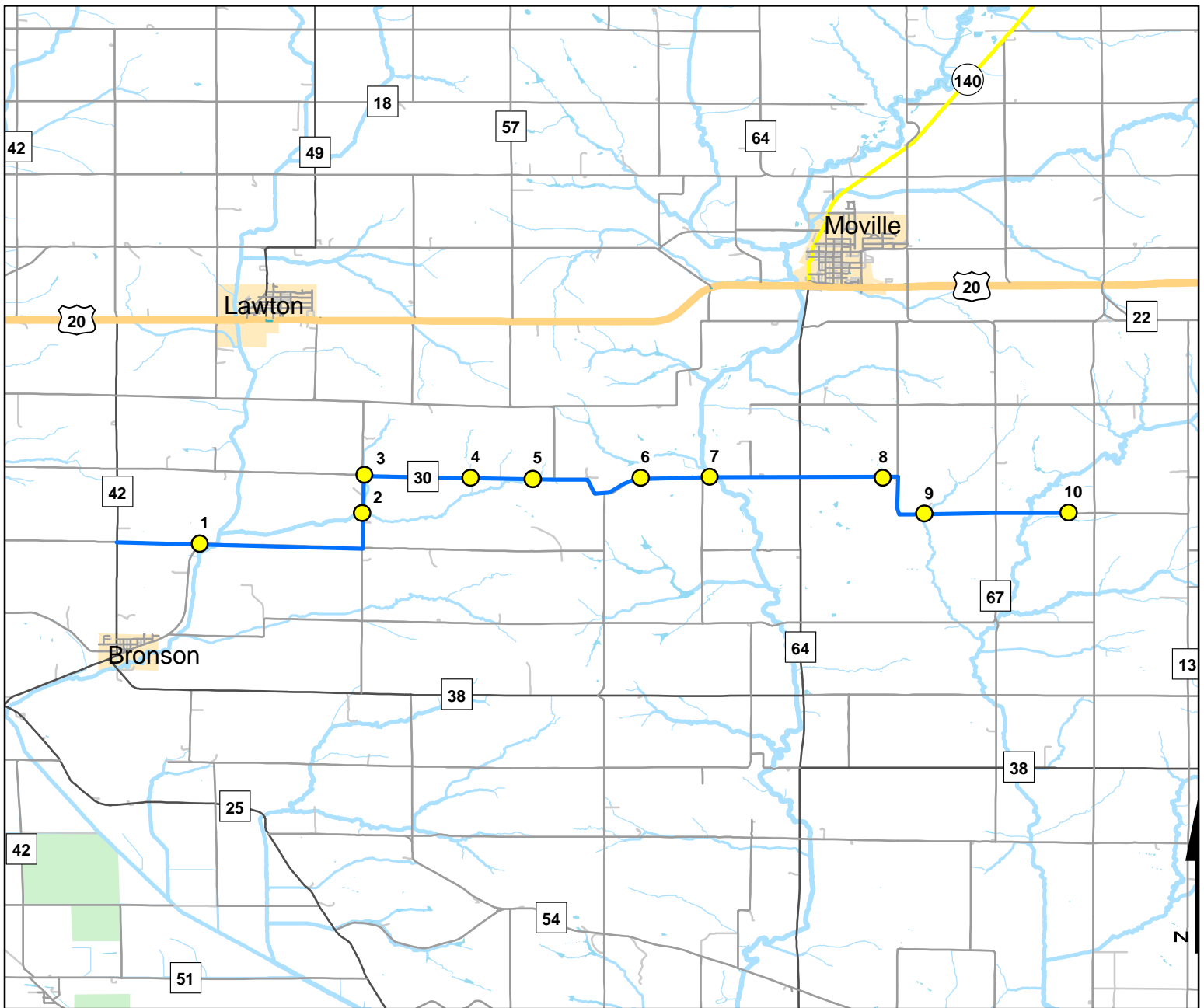

Legend

● Stop Locations

— Route Path

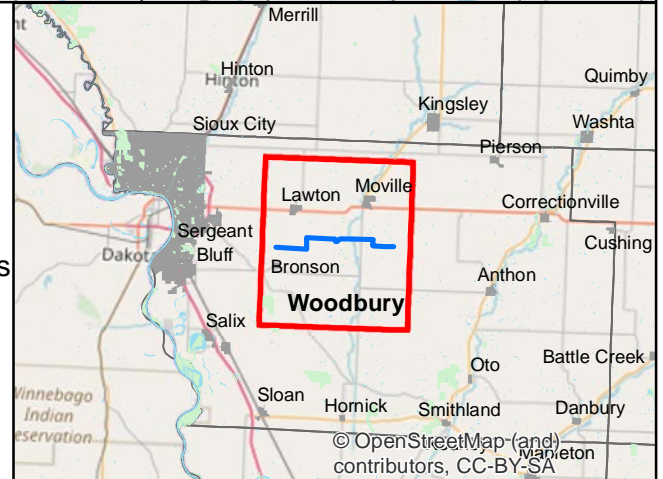



Frog and Toad Call Survey Route Description

Route ID **360107**

Established:

Site Number	Name	County	Latitude	Longitude	Directions
1	0.8	Woodbury	42.4305992	-96.1969986	Drive east on 190th from intersection with K42-Delaware Ave. Stop at the intersection with Eastland Ave. Field corner flooded on the southwest corner of the intersection. Bridge up ahead ~75 yards.
2	2.9	Woodbury	42.4365997	-96.1647034	Turn north (left) on Emmett Ave. Stop is at a small creek running between farm fields crossing under road. Flow is a little fast...
3	3.5	Woodbury	42.4443016	-96.1641998	Turn east (right) on 180th St. Stop immediately at creek running through culverts. Right side is a little marshy and pools in a place or two.
4	4.6	Woodbury	42.4436989	-96.1430969	Continue east on 180th. Stop at another small creek - cut banks in pasture on left, between crop fields on right. Valley between hills.
5	5.2	Woodbury	42.4435005	-96.1307983	Continue east on 180th. Wet mucky wooded patch on left side of road across from white house with wood porch. Associated with a creek just before you get to Garner Ave.
6	6.7	Woodbury	42.4436989	-96.1092987	Continue east on 180th. Two different maps indicate there is a pond on the left hand side of the road in the wooded hollow but it is not visible from the road.
7	7.6	Woodbury	42.4439011	-96.0954971	Continue east on 180th, Stop just before bridge over the West Fork of the Little Sioux. On right side among trees is a small pool and wet ditch. River just 20 yards ahead.



Frog and Toad Call Survey Route Description

8	9.4	Woodbury	42.4436989	-96.060997	Continue east on 180th. Just before you reach the roads end there are 3 artificial looking ponds in a pasture on the left side of the road.
9	10.3	Woodbury	42.4365005	-96.052803	At the intersection take a right on Humbolt and then follow around to the left onto 185th. After the turn on 185th stop at the 1st bridge. CReek runs on both sides, best habitat on left.
10	11.8	Woodbury	42.4366989	-96.0240021	Large Marshy area with cattails and trees on right side of road. Across from a farmstead #2967. Small farm pond on left.