

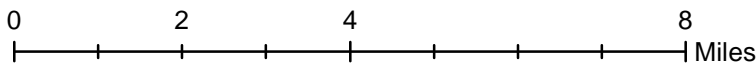

Volunteer Wildlife Monitoring Program (VWMP) Frog and Toad Survey

Route ID: 261 County: Madison

Click for Google Maps to Site 1: <https://www.google.com/maps/dir/?api=1&destination=41.2954683246,-94.0750490455>

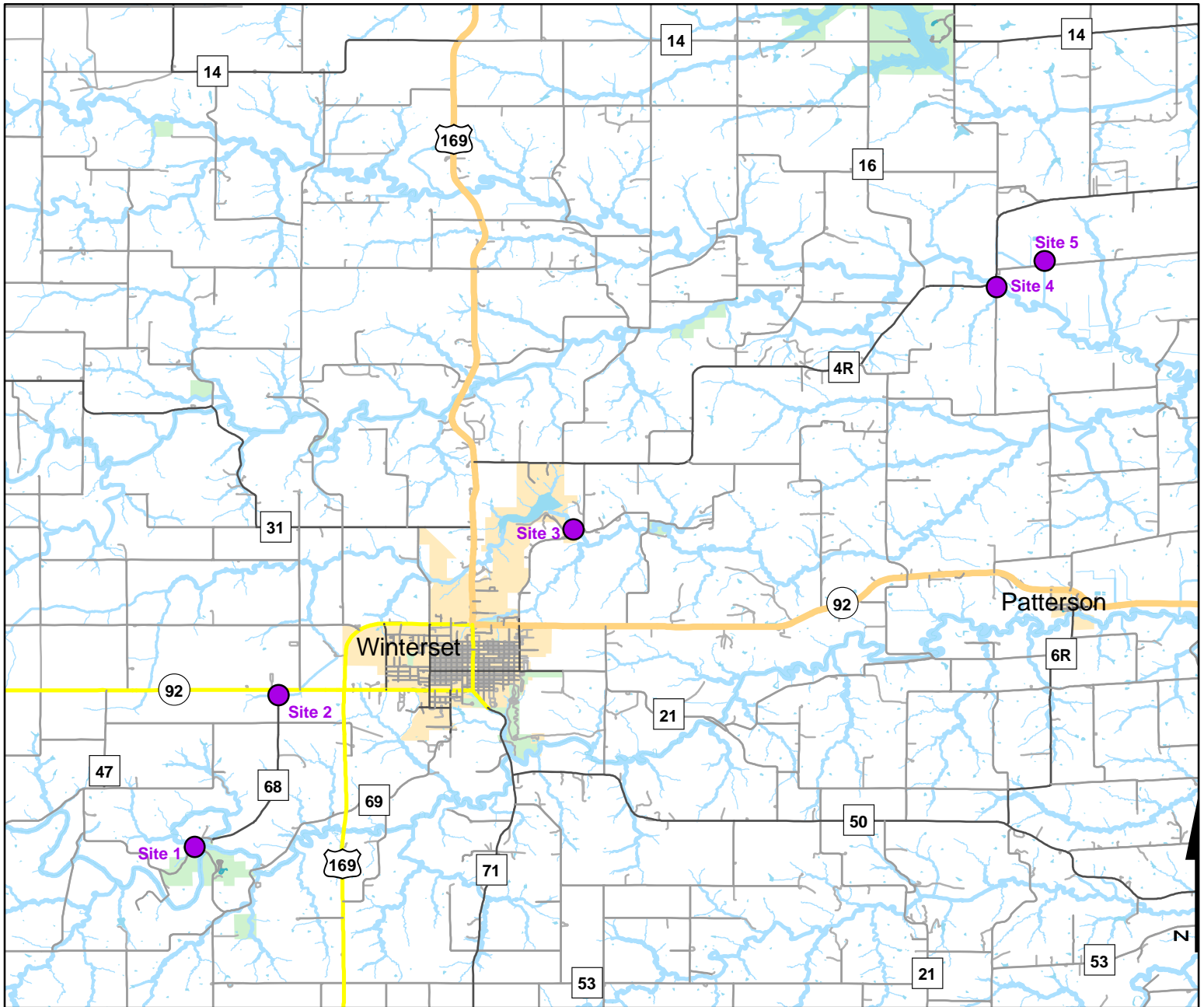

**Volunteer
Wildlife
Monitoring
Program**

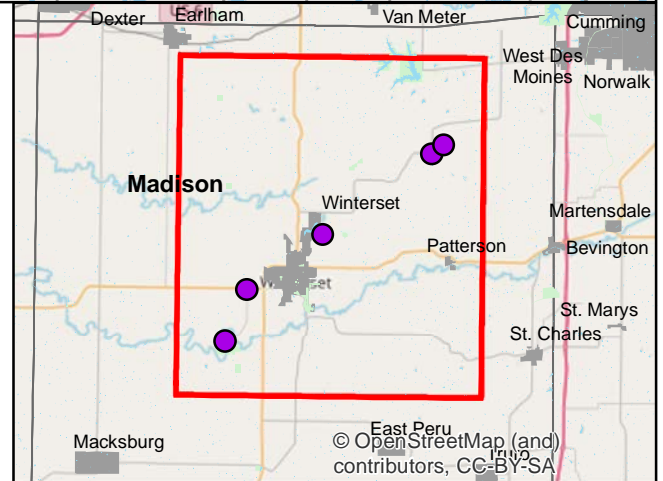



Volunteer Wildlife Monitoring Program (VWMP) Frog

Route ID: 261 County: Madison

Click for Google Maps to Site 1: <https://www.google.com/maps/dir/?api=1&destination=41.2954683246,-94.0750490455>

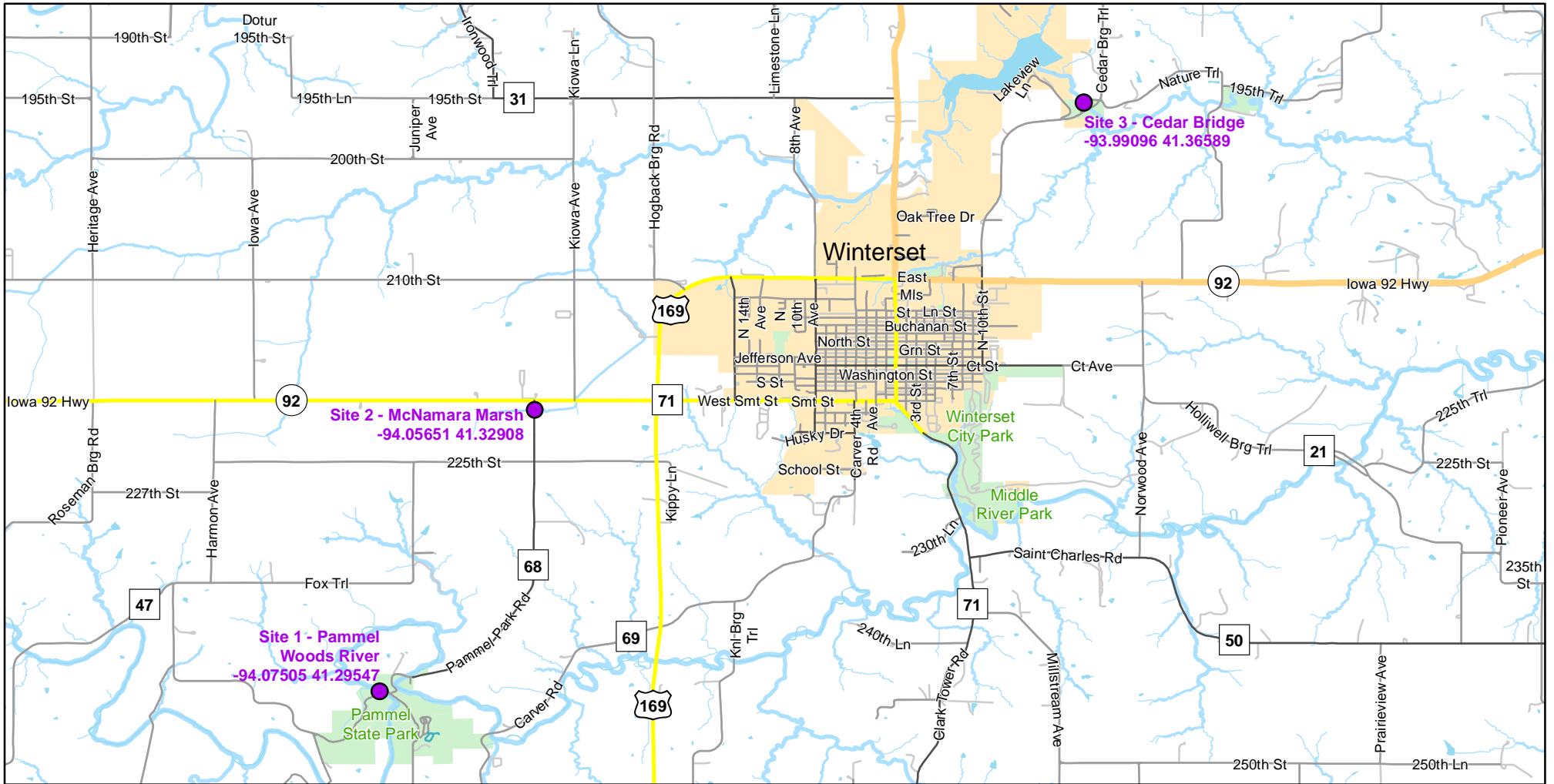

Enlarged View of Site 1



Legend

----- Trails

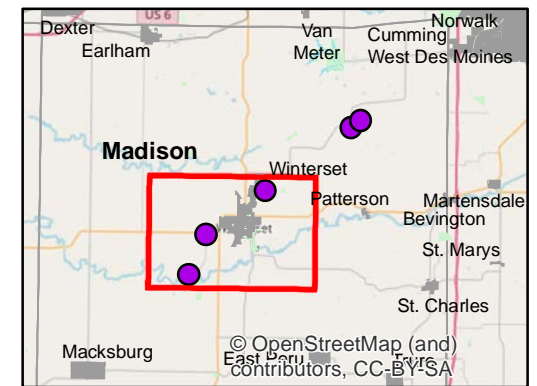
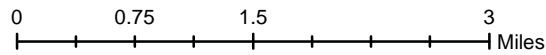



Volunteer Wildlife Monitoring Program (VWMP) Frog and Toad Survey

Route ID: 261 County: Madison

Click for Google Maps to Site 1: <https://www.google.com/maps/dir/?api=1&destination=41.2954683246,-94.0750490455>

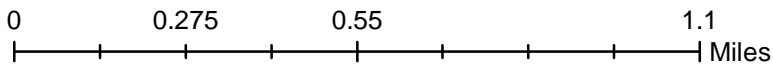
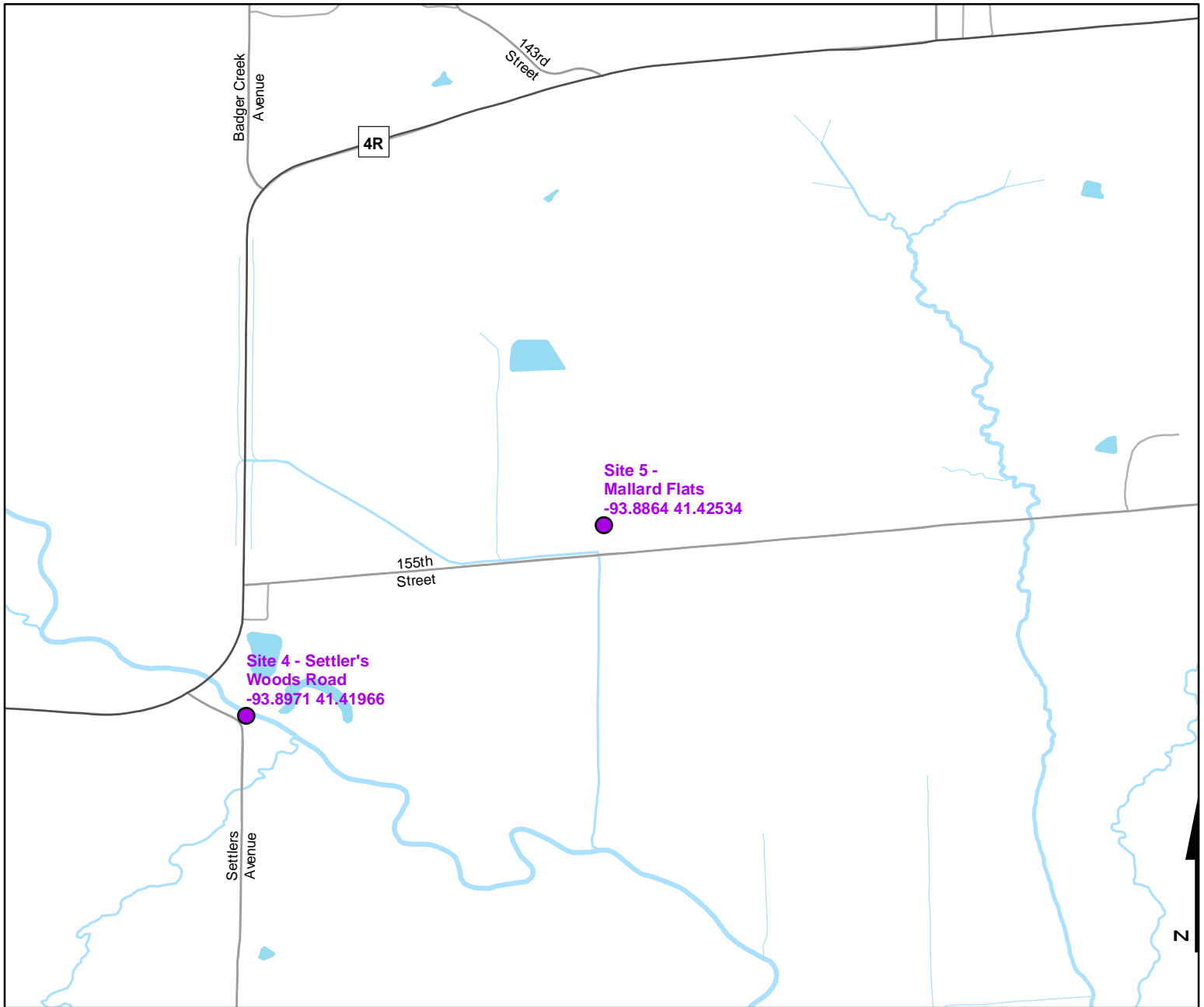

Volunteer Wildlife Monitoring Program

Legend

----- Trails

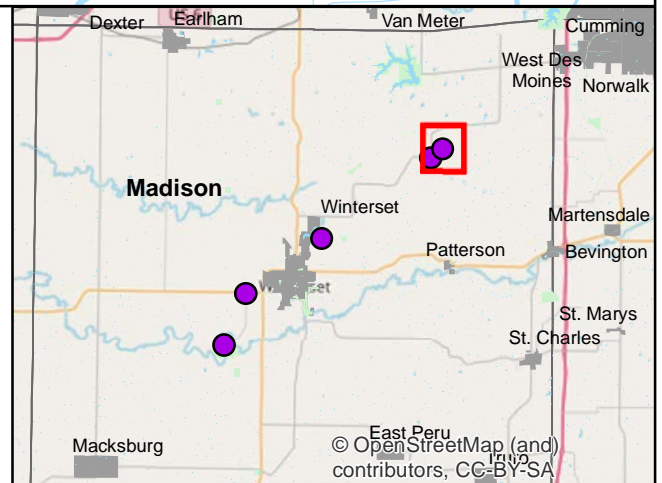



Frog and Toad Call Survey Route Description

Route ID **261**

Established: 2008

| Site Number | Name | County | Latitude | Longitude | Directions |
|-------------|----------------------|---------|------------|-------------|---|
| 1 | Pammel Woods River | Madison | 41.2954683 | -94.075049 | On Pammel Park Rd on bridge over Middle River, close to Pammel Park Tr |
| 2 | McNamara Marsh | Madison | 41.3290851 | -94.0565058 | Marsh at the intersection of Pammel Park Rd and Hwy 92, south eastern corner of intersection |
| 3 | Cedar Bridge | Madison | 41.3658873 | -93.9909576 | Cedar Covered Bridge: 1874 Nature Ct, Winterset, IA 50273 |
| 4 | Settler's Woods Road | Madison | 41.4196574 | -93.8970964 | Woods surrounding the North River on the eastside of Settlers Ave, south of intersection with G4R |
| 5 | Mallard Flats | Madison | 41.4253429 | -93.8864039 | Wetlands on both sides of 155th St just east from intersection with G4R |