

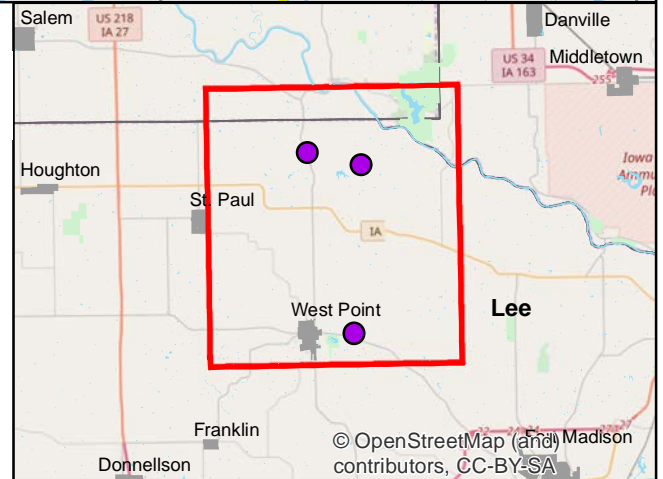

Volunteer Wildlife Monitoring Program (VWMP) Frog and Toad Survey

Route ID: 186 County: Lee

Click for Google Maps to Site 1: <https://www.google.com/maps/dir/?api=1&destination=40.7159660974,-91.4251590819>

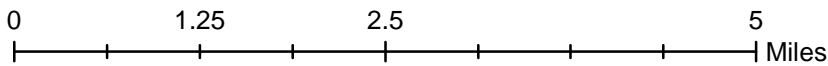
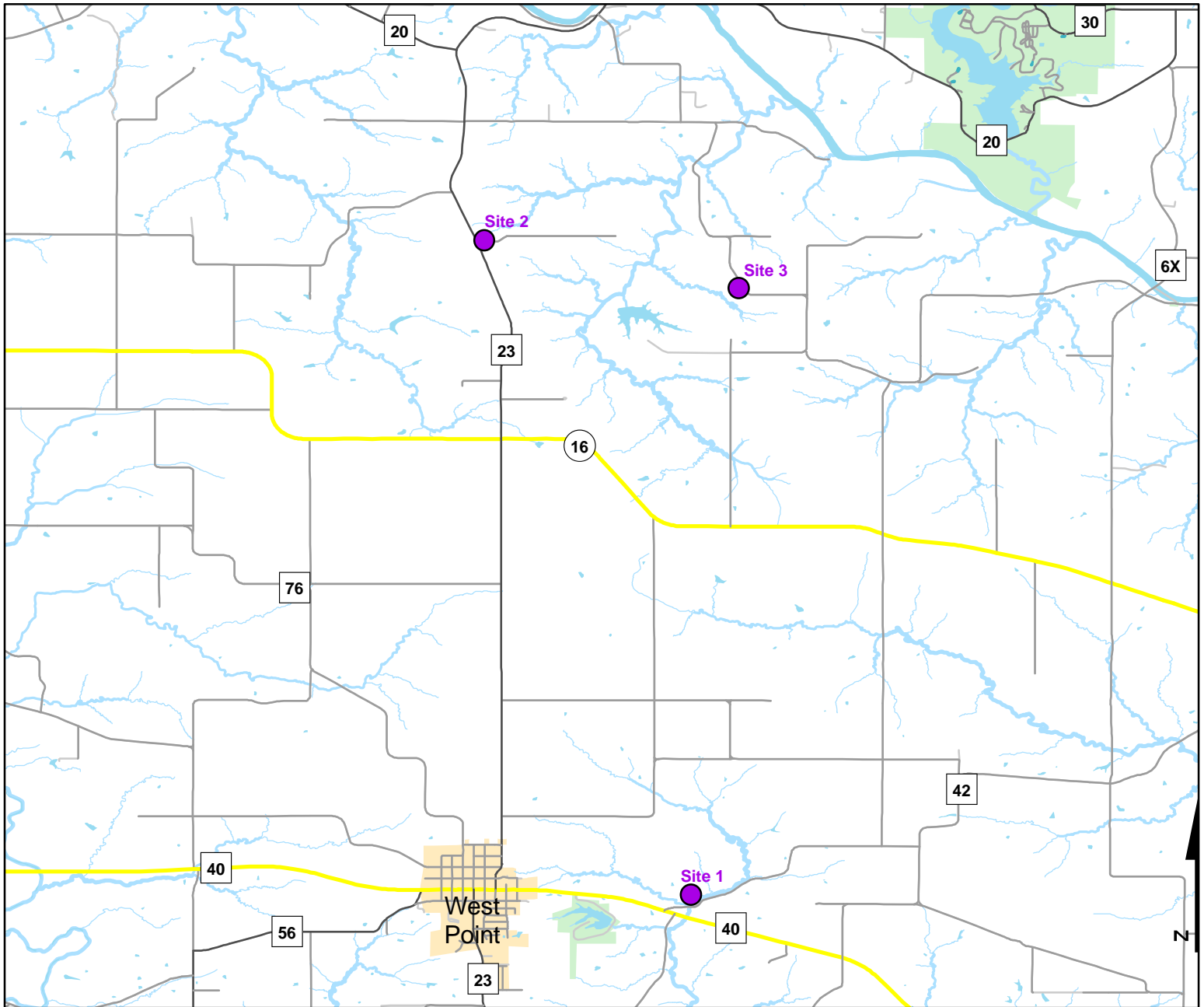

© OpenStreetMap (and) Madison contributors, CC-BY-SA



Volunteer Wildlife Monitoring Program (VWMP) Frog and Toad Survey

Route ID: 186 County: Lee

Click for Google Maps to Site 1: <https://www.google.com/maps/dir/?api=1&destination=40.7159660974,-91.4251590819>

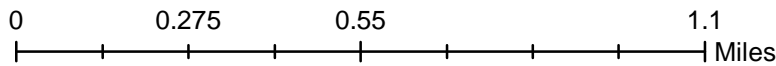
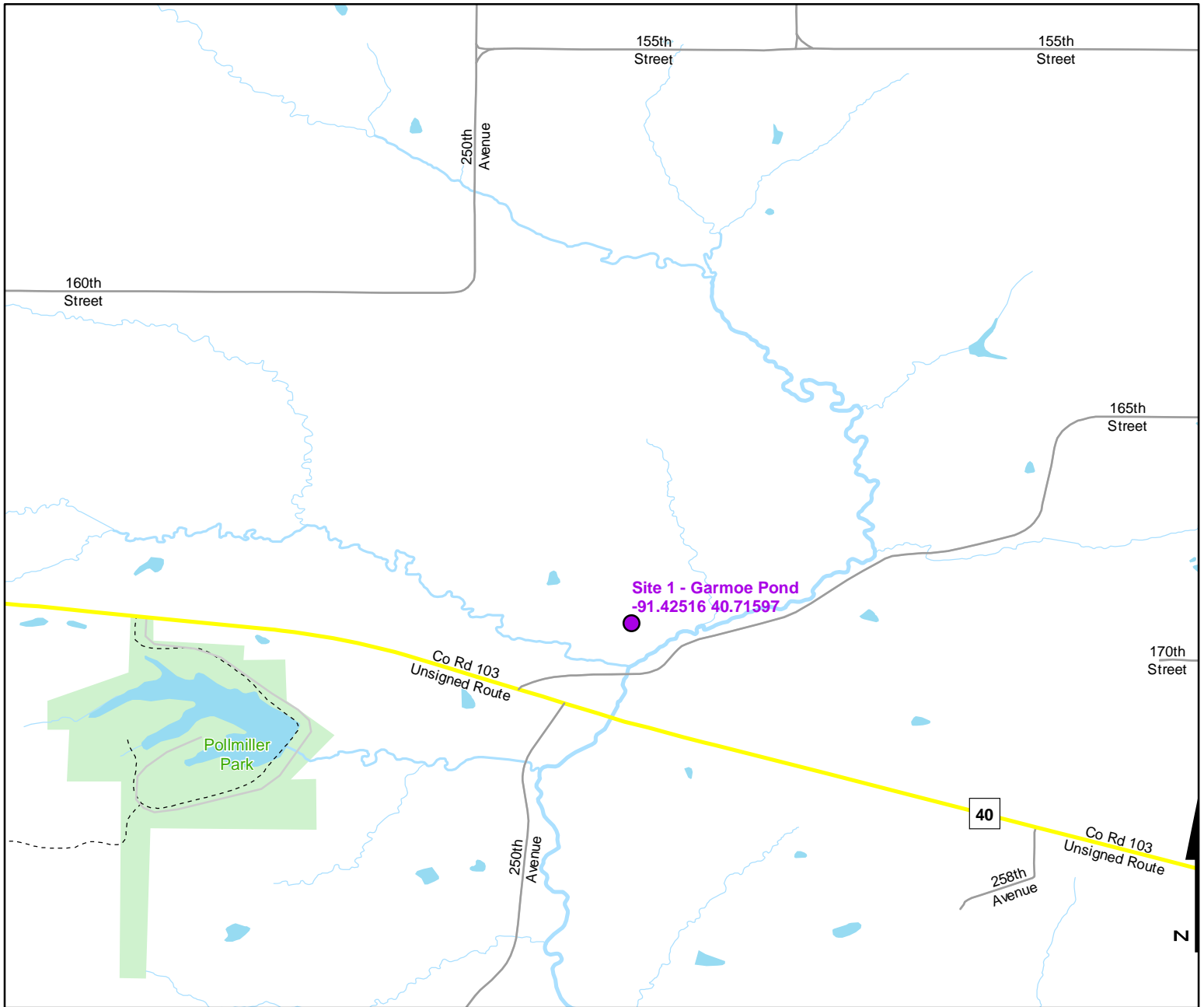

DNR
**Volunteer
 Wildlife
 Monitoring
 Program**

Legend

----- Trails

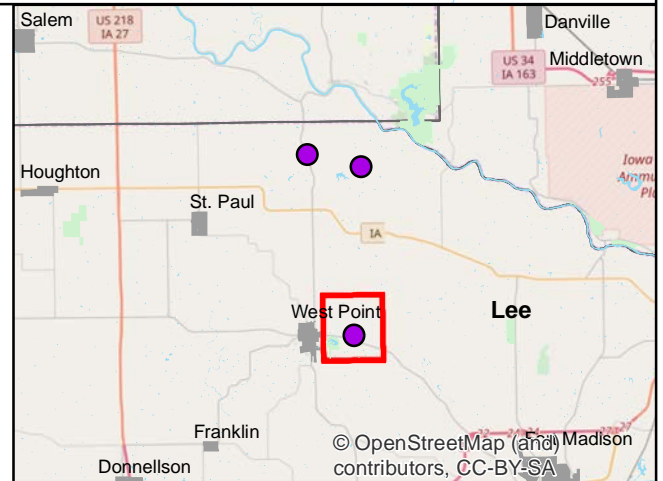

© OpenStreetMap (and) Madison contributors, CC-BY-SA



Volunteer Wildlife Monitoring Program (VWMP) Frog and Toad Survey

Route ID: 186 County: Lee

Click for Google Maps to Site 1: <https://www.google.com/maps/dir/?api=1&destination=40.7159660974,-91.4251590819>

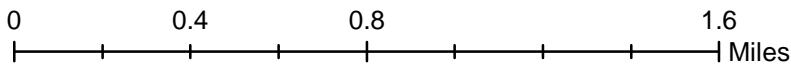
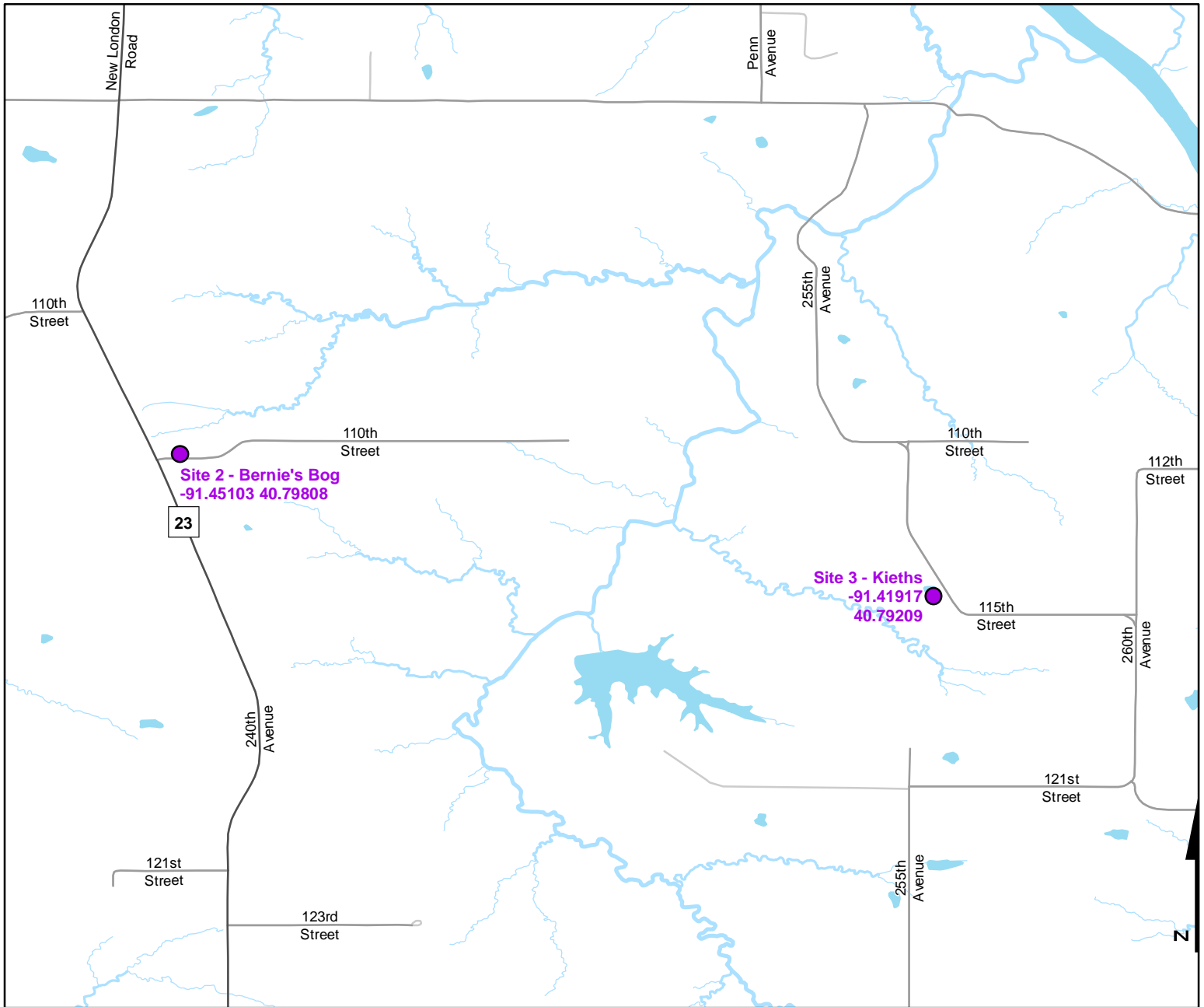

Legend

----- Trails

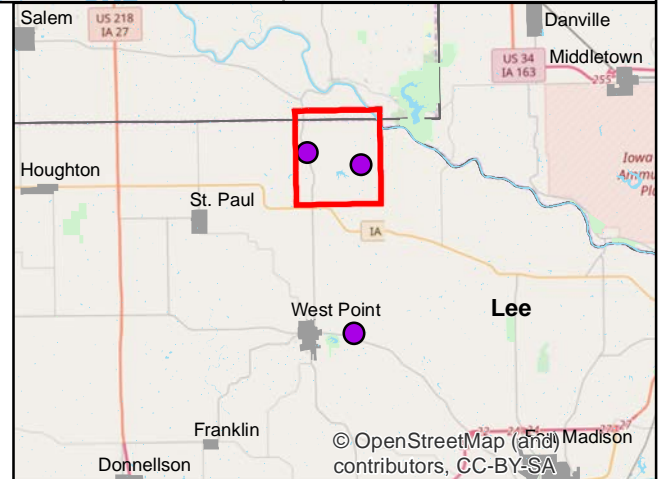



Frog and Toad Call Survey Route Description

Route ID **186**

Established: 1998

Site Number	Name	County	Latitude	Longitude	Directions
1	Garmoe Pond	Lee	40.7159661	-91.4251591	11/20/2008 Sent e-mail to Fullenkamps to narrow down site location. Pond north of 155th St off of Co. Rd. J40 intersection. Listen from 155th St.
2	Bernie's Bog	Lee	40.798083	-91.4510282	On the intersection of 240th Ave and 110th St. North of 10th Ave.
3	Kieths	Lee	40.7920928	-91.4191655	Just north of the curve when 115th St changes to 255th Ave, on the west side of 255th Ave