

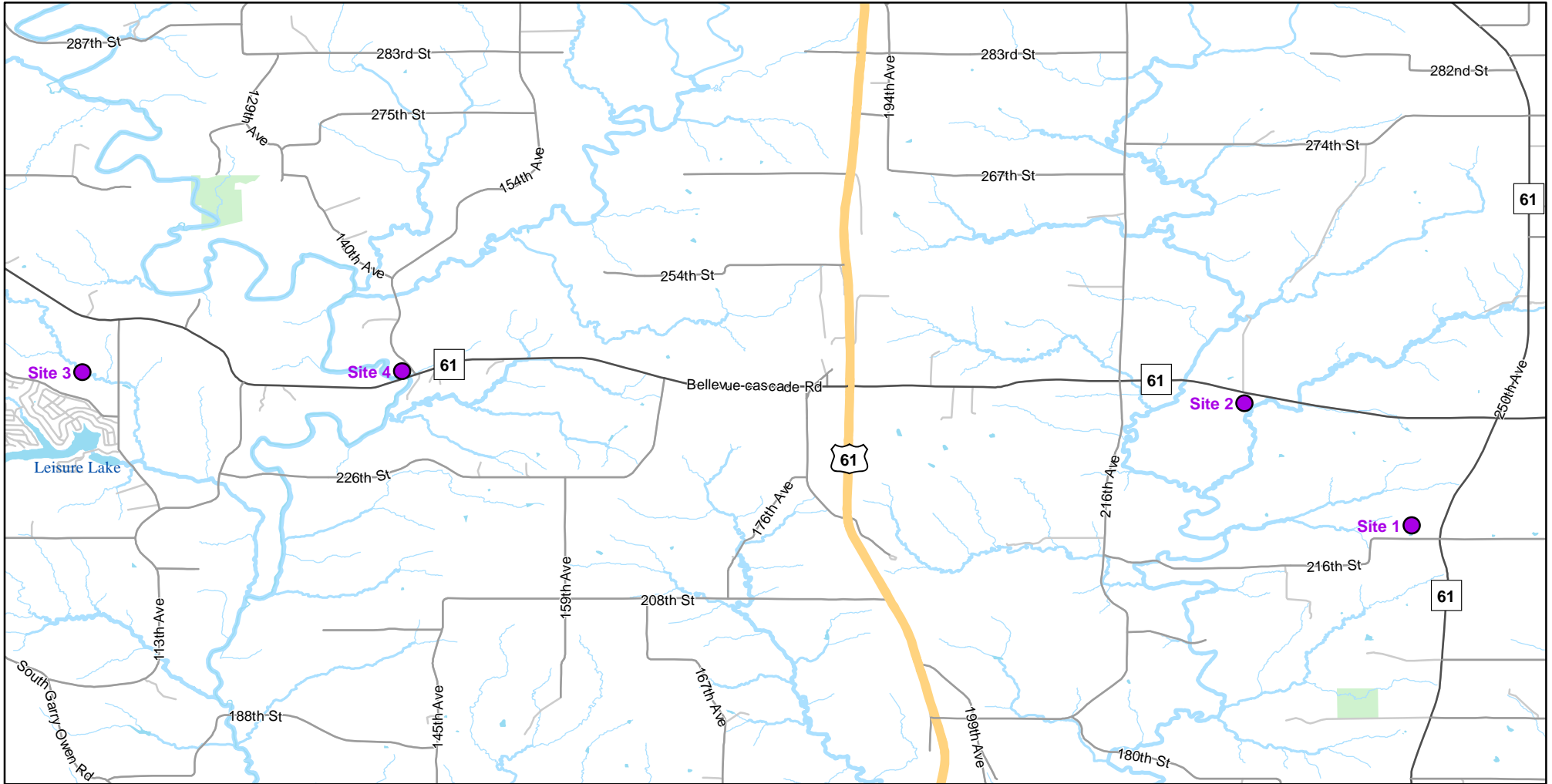

Volunteer Wildlife Monitoring Program (VWMP) Frog

Route ID: 149 County: Jackson

Click for Google Maps to Site 1: <https://www.google.com/maps/dir/?api=1&destination=42.2236556558,-90.6124520521>



Enlarged View of Site 3

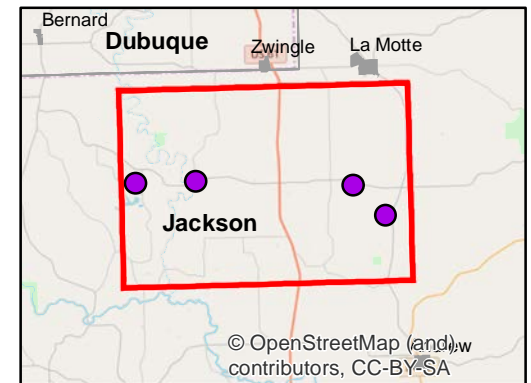
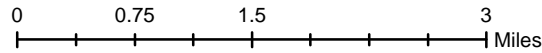



Volunteer Wildlife Monitoring Program (VWMP) Frog and Toad Survey

Route ID: 149 County: Jackson

Click for Google Maps to Site 1: <https://www.google.com/maps/dir/?api=1&destination=42.2236556558,-90.6124520521>

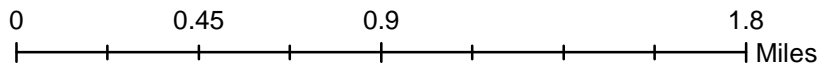
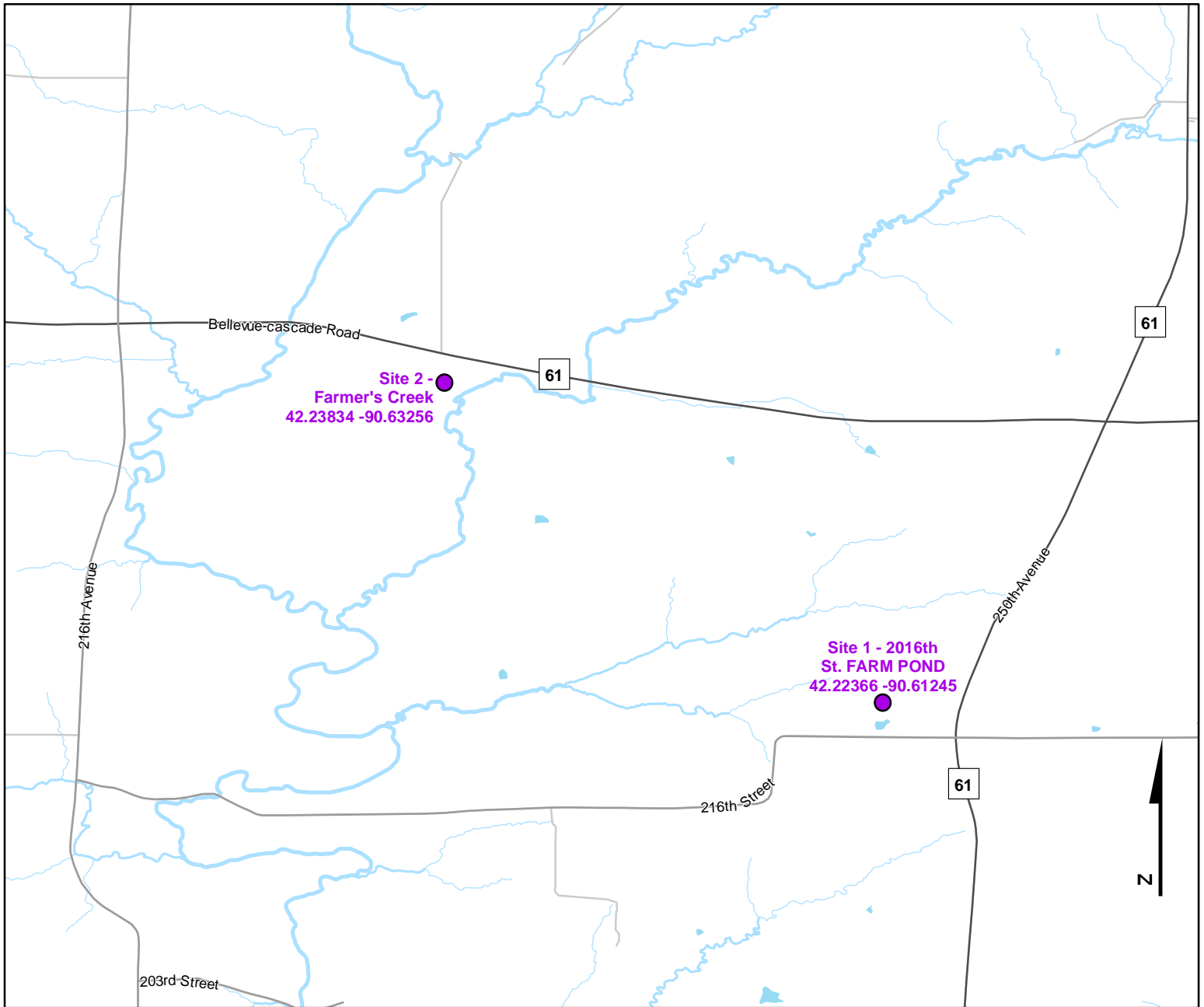

Legend

----- Trails

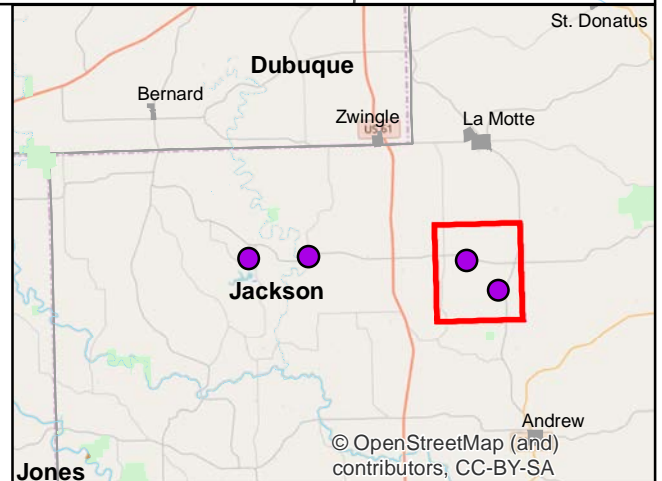



Volunteer Wildlife Monitoring Program (VWMP) Frog and Toad Survey

Route ID: 149 County: Jackson

Click for Google Maps to Site 1: <https://www.google.com/maps/dir/?api=1&destination=42.2236556558,-90.6124520521>

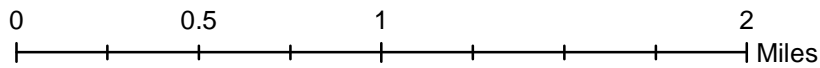
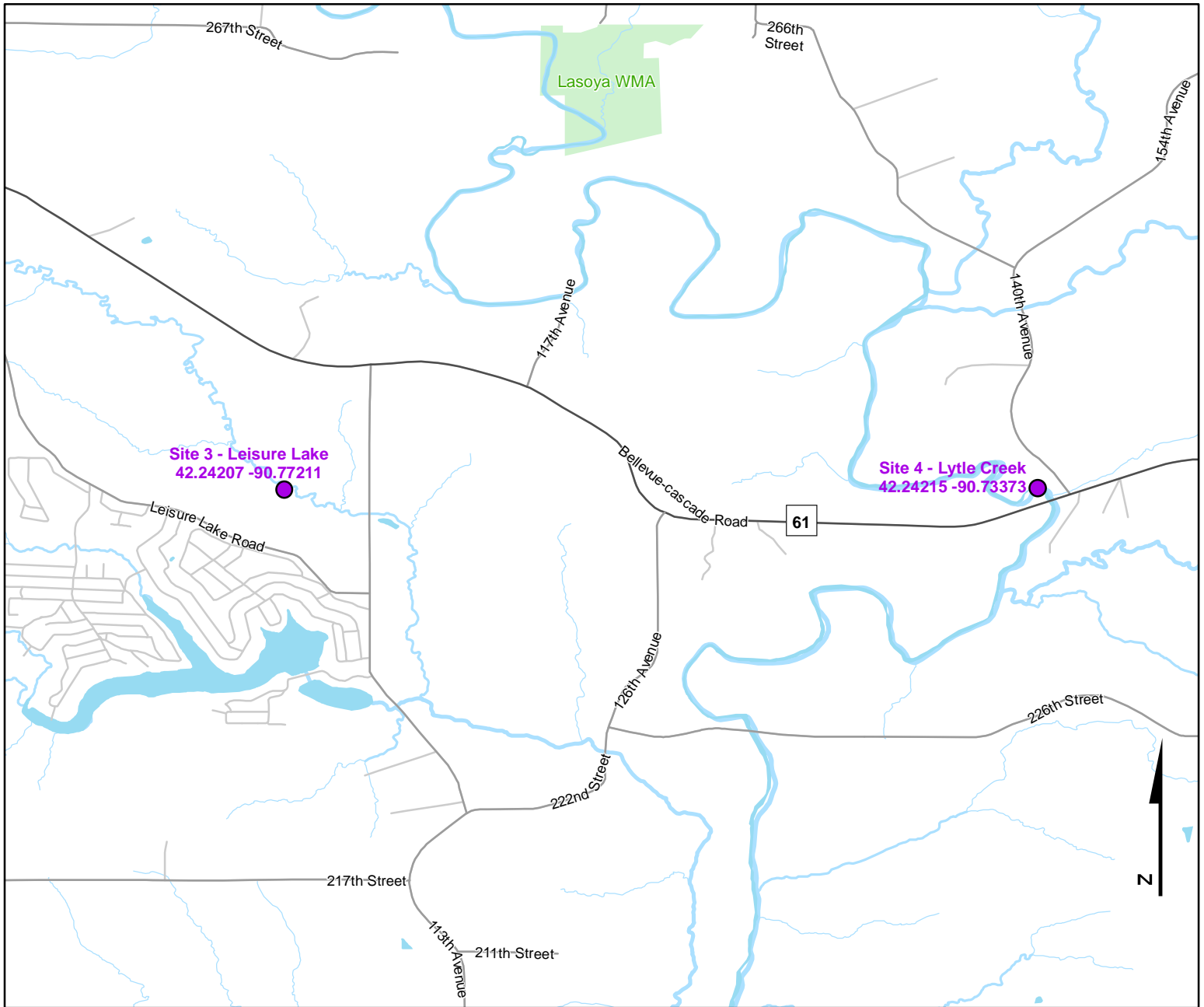

Legend

----- Trails

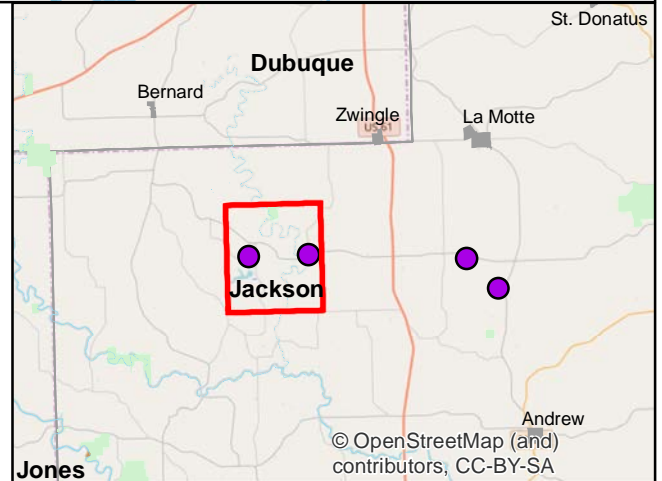



Frog and Toad Call Survey Route Description

Route ID **149**

Established: 1994

Site Number	Name	County	Latitude	Longitude	Directions
1	2016th St. FARM POND	Jackson	42.2236557	-90.6124521	NW of Co Rd Y61 and 216th Ave intersection
2	Farmer's Creek	Jackson	42.2383397	-90.6325612	Sout-side of Bellevue Cascada Rd, 3/4 miles east of Bellevue Cascade Rd and 216th Ave intersection. Small creek
3	Leisure Lake	Jackson	42.2420732	-90.7721116	
4	Lytle Creek	Jackson	42.242145	-90.7337315	On Bellevue Cascade Rd, on bridge over Lytle Creek