

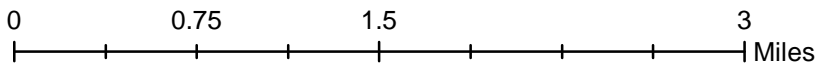

Volunteer Wildlife Monitoring Program (VWMP) Frog and Toad Survey

Route ID: 63 County: Monona

Click for Google Maps to Site 1: <https://www.google.com/maps/dir/?api=1&destination=42.1088016186,-95.9279483379>

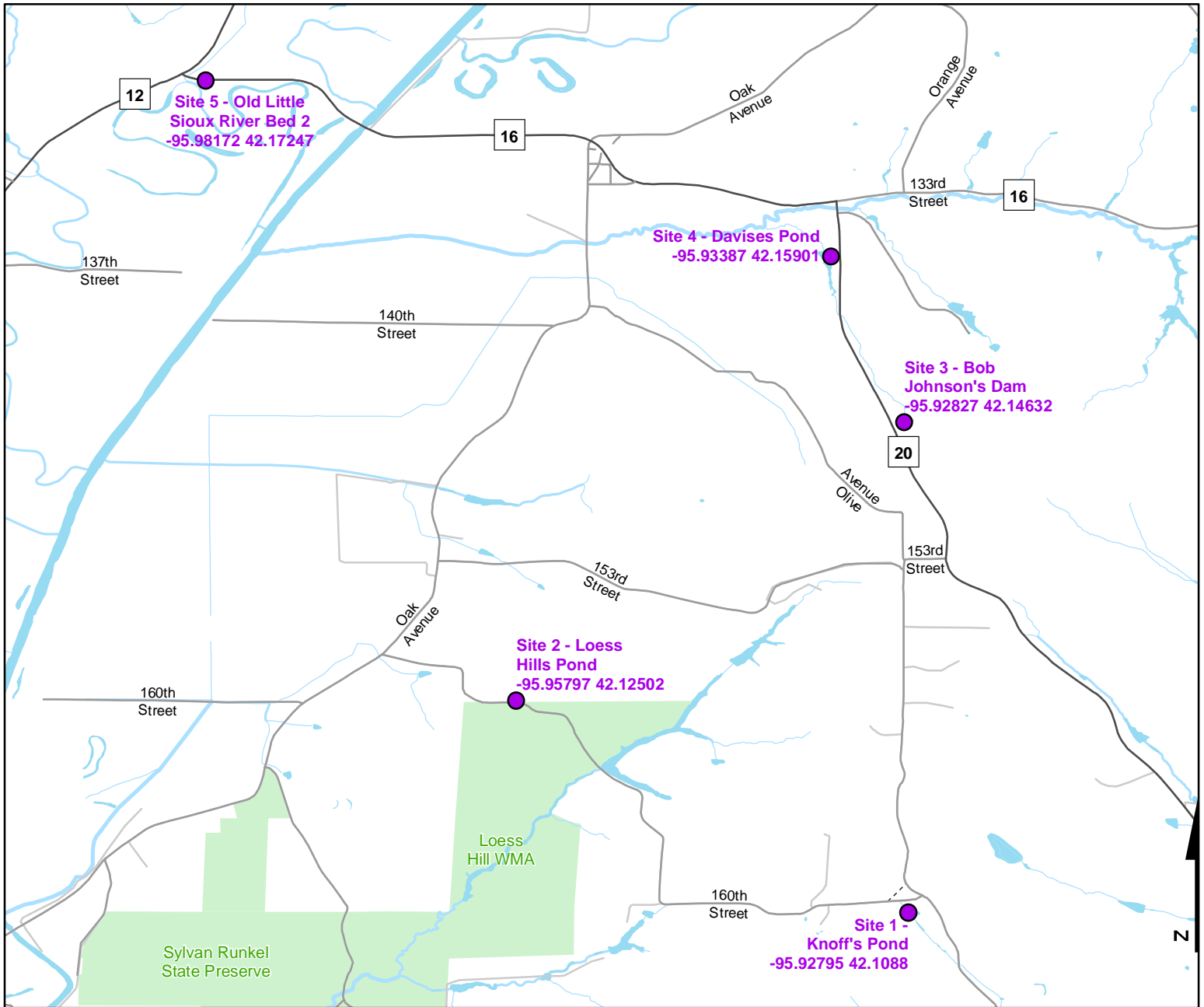

DNR
Volunteer Wildlife Monitoring Program

Legend

----- Trails

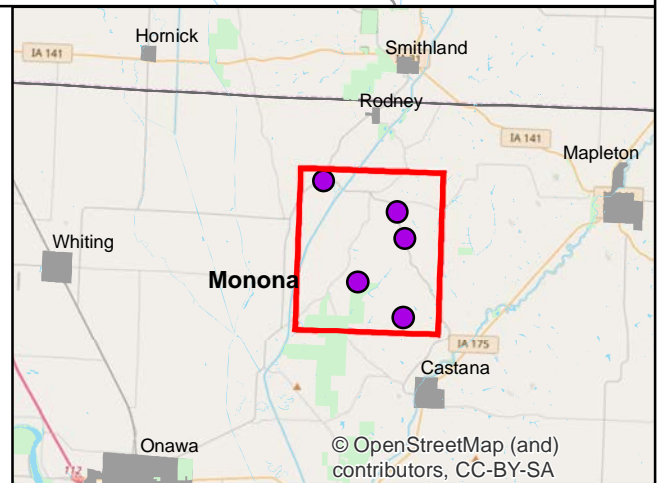



Frog and Toad Call Survey Route Description

Route ID **63**

Established: 1992

| Site Number | Name | County | Latitude | Longitude | Directions |
|-------------|------------------------------|--------|------------|-------------|---|
| 1 | Knoff's Pond | Monona | 42.1088016 | -95.9279483 | Just West of the 160th St. and Olive Ave. Intersection |
| 2 | Loess Hills Pond | Monona | 42.1250239 | -95.9579701 | About 0.5 miles east of 160th St. and Oak Ave. On the North side of the road |
| 3 | Bob Johnson's Dam | Monona | 42.1463183 | -95.9282742 | East side of Co. Hwy. L20 |
| 4 | Davises Pond | Monona | 42.1590076 | -95.9338705 | 0.3 Miles south of 133rd St. and Co. Hwy. L20 intersection. On the West side of L20 |
| 5 | Old Little Sioux River Bed 2 | Monona | 42.1724695 | -95.9817181 | Just east of the intersection of Co. Hwy. L12 and Co. Hwy. E16 |