

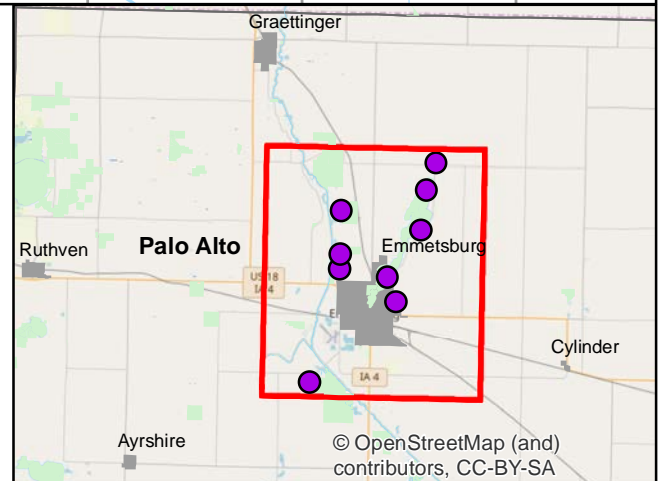

# Volunteer Wildlife Monitoring Program (VWMP) Frog and Toad Survey

Route ID: 29 County: Palo Alto

Click for Google Maps to Site 1: <https://www.google.com/maps/dir/?api=1&destination=43.1338126943,-94.699231752>

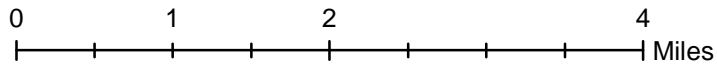
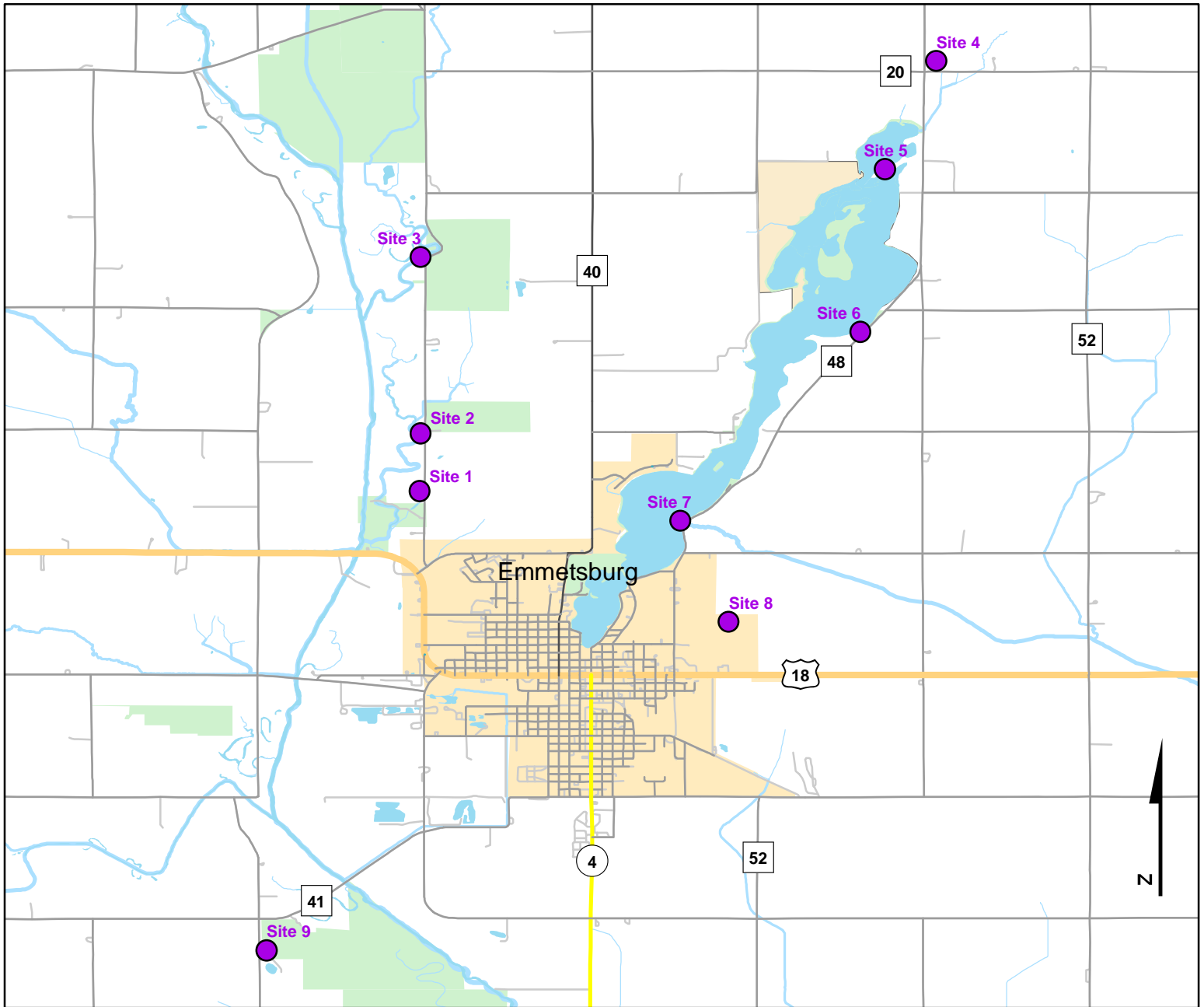



# Volunteer Wildlife Monitoring Program (VWMP) Frog and Toad Survey

Route ID: 29 County: Palo Alto

Click for Google Maps to Site 1: <https://www.google.com/maps/dir/?api=1&destination=43.1338126943,-94.699231752>

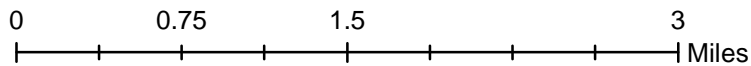
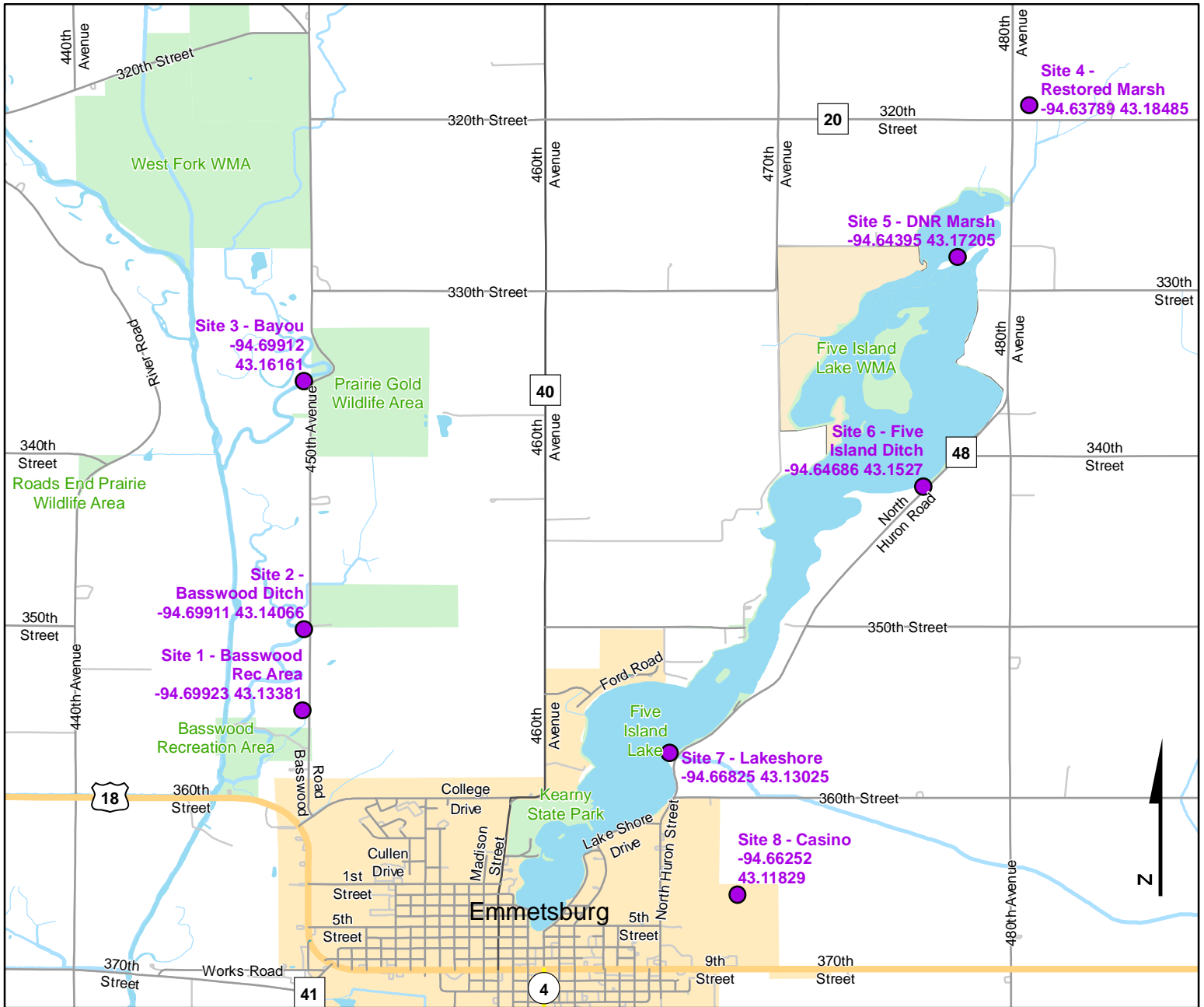

**DNR**  
**Volunteer Wildlife Monitoring Program**

## Legend

----- Trails

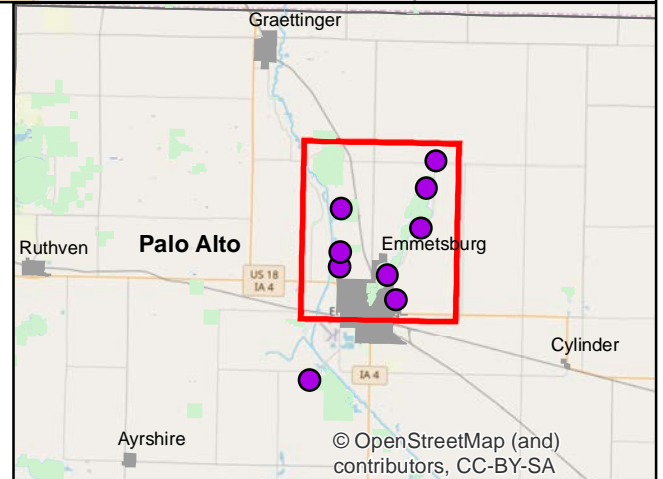



# Volunteer Wildlife Monitoring Program (VWMP) Frog and Toad Survey

Route ID: 29 County: Palo Alto

Click for Google Maps to Site 1: <https://www.google.com/maps/dir/?api=1&destination=43.1338126943,-94.699231752>

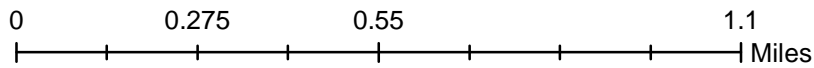
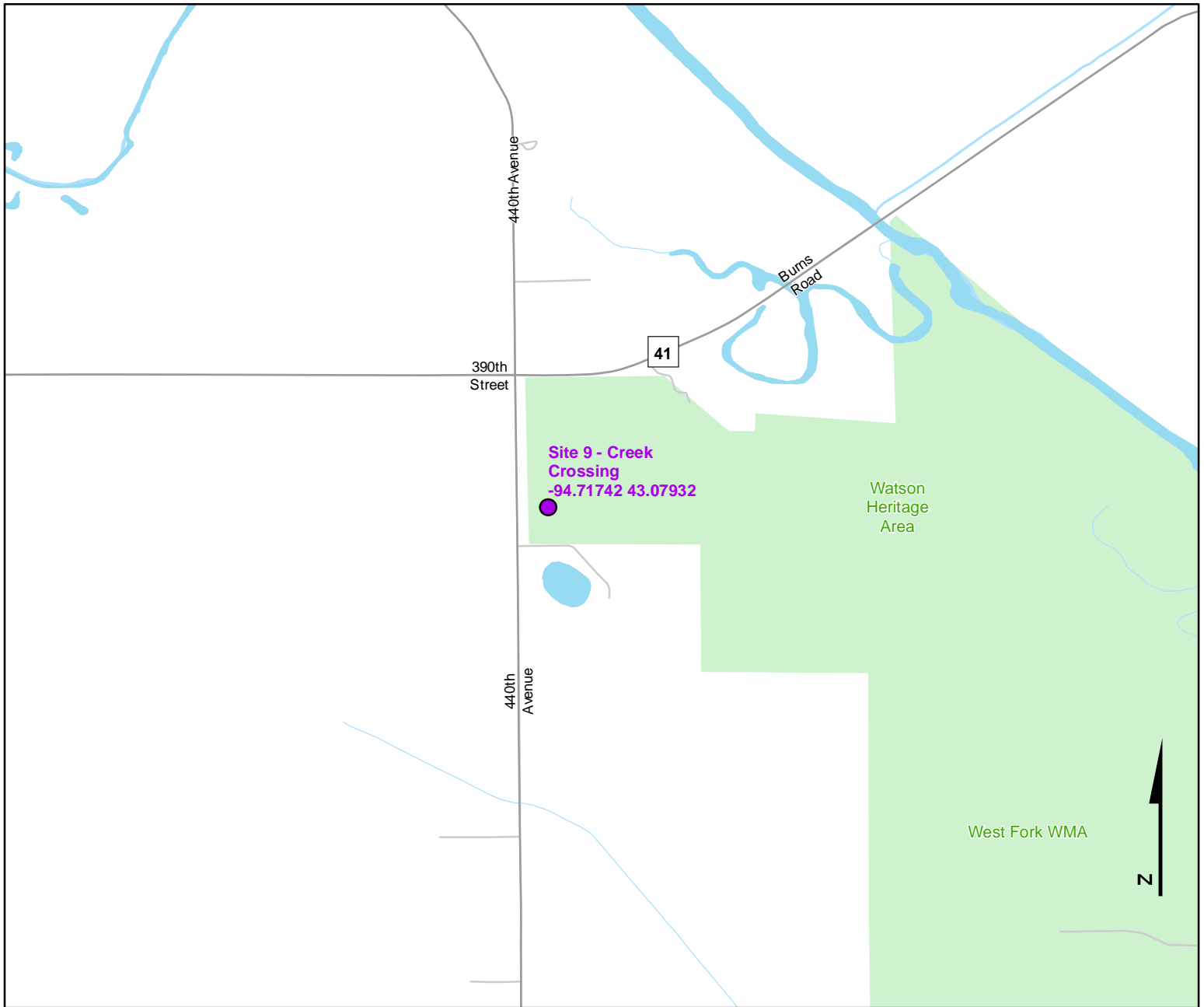

## Legend

----- Trails

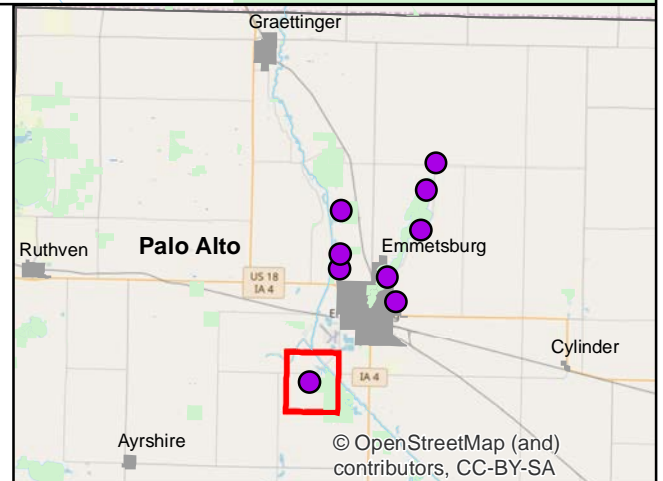



# Frog and Toad Call Survey Route Description

Route ID **29**

Established: 1991

Site Number	Name	County	Latitude	Longitude	Directions
1	Basswood Rec Area	Palo Alto	43.1338127	-94.6992318	North side
2	Basswood Ditch	Palo Alto	43.1406579	-94.699114	Ditch north of Basswood Rec Area
3	Bayou	Palo Alto	43.1616116	-94.6991165	West Des Moines River Bayou
4	Restored Marsh	Palo Alto	43.184845	-94.6378899	Restored Marsh NE of Five Island Lake
5	DNR Marsh	Palo Alto	43.1720527	-94.6439454	DNR Marsh North End of Five Island Lake
6	Five Island Ditch	Palo Alto	43.152705	-94.6468579	Ditch east side of Five Island Lake
7	Lakeshore	Palo Alto	43.1302527	-94.6682498	
8	Casino	Palo Alto	43.1182879	-94.6625162	
9	Creek Crossing	Palo Alto	43.0793151	-94.717416	